



# NEW HANSE 575 – Press Manual

- INTRODUCTION
- CONCEPT
- TARGET GROUP & CUSTOMER NEEDS
- WHAT'S NEW ?
- TECHNICAL DETAILS
- SAIL PLAN
- DECK LAYOUT
- INTERIOR LAYOUTS
- DINGHY GARAGE
- PERFORMANCE
- NAVIGATION PACKAGES
- ENTERTAINMENT PACKAGES
- BIMINI & SPRAYHOOD
- BENEFITS
- UNIQUE SELLING POINTS
- HANSE 545 vs 575
- LAUNCH SCHEDULE





## Introduction of the new Hanse 575



The best statement related to the New Hanse 575 was once said by a famous American astronaut Neil Armstrong *"That's one small step for man, one giant leap for mankind"* when for the first time in the history making a step on the surface of the moon. Moonwalking we call a period of designing the new Hanse 575 - it was a romantic time of collecting ideas, brainstorming about various solutions, features, shapes...



## Introduction of the new Hanse 575



The new Hanse 575 gathers all the latest achievements in terms of hull and interior design with a significant upgrade of the deck functionality and safety onboard. **Hanse's** legendary easy handling concept is reflected in standard self tacking jib, full batten main sail, maneuvering winches, halyards and sheets lead to helm position together with perfectionists from judel/vrolijk & co, who designed the shapes of the hull which is optimized for speed and high stability while sailing.





Dinghy garage large enough for a Jet powered dinghy with a tender launching system will be hard to beat in the competition for the most popular gadget on board.

Lots of natural light down below emphasizes even more carefully designed interior furniture with generous longitudinal galley, “loft style” feel saloon, newly developed companionway entrance and luxurious owner’s and guests cabins.

## Concept: comfortable, easy, safe & innovative



- Judel/vrolijk & co designed hull with long LWL and outstanding beam
- Higher freeboards provide solid and high bulwark which enables very safe movement on the side decks
- The deck layout has been developed for fast cruising with optimum deck gear distribution and a “one step” high coach roof for safety
- Sandwich construction hull and deck, with a robust GRP inner grid, keel stepped mast with chain plates integrated into the toe rail
- 50 degrees companionway stairs angle
- Versatile interior layout options
- 2 large heads aft and separate shower and head in front \*
- Large bathing platform
- Longitudinal generous galley on port
- Longitudinal dinghy garage with launching system for jet tender \*
- Comfortable cockpit with retractable double tables for sun bathing \*
- Full batten or furling mainsail system
- Retractable saloon table for lounge feel \*
- Less “edgy” interior design with lots of storage space
- Lots of natural light inside
- Easy sailing

\*optional



# NEW 575 YACHT DESIGN – A STEP FURTHER

**COCKPIT DESIGN** The best and most innovative cockpit in the class with very comfortable backrest angles, fridge and lots of space for the whole crew. The sturdy cockpit tables are easy to convert into a large sunbathing and relaxing area of 4.6 m<sup>2</sup>.

**INNOVATIVE ENGINEERING** Double helmsman position with tablets for navigation instruments and comfortable seats. All halyards, main and genoa sheet, trim and reefing lines are along side and easy to handle from the steering wheel. Large, hydraulic powered bathing platform and jet tender launching system with rollers.

**COMPANIONWAY** The coach roof close to the companionway is free of winches and gear, so there is lots of side space for cup holders and trays plus watertight storage scoops for mobile phones and other small personal belongings. Long, easy access to below decks with low threshold and optimized staircase angle of 50°. Operable flush port lights for natural light and ventilation in aft cabins.

**LIGHT & VENTILATION** Ample light and ventilation provision via 12 large operable flush hatches above owners/front cabins, front and rear heads and saloon. Four of them elegantly curved around coach roof edges.

**NEW LEVEL OF DESIGN** Elegant hull to deck joint with solid and safe bulwark from 14 to 8 centimetres height eliminated toe rail fixing. Deck and hull (above WL) laminated with vinyl ester resin to give a strong and light sandwich construction with balsa core. Integrated genoa haler and multifunctional bow fitting with anchor roller, solid teak step and gennaker attachment point.



**HULL WINDOWS** Elegant double hull windows in front and aft cabins. Two large hull windows per side in the saloon and for cooking with a sea view in the galley. Safe and strong chain plates integrated in bulwark positioned for spreader angles of 20 degrees.

**HALYARD MANAGEMENT** All halyards, sheets, trimming and reefing lines run completely covered below the deck aft to the helmsman positions. Extra genoa track with pin stop cars for optional larger 105% genoa. Hanse invented self-tacking-jib-system for single-handed manoeuvres without crew assistance.

**STOWAGE** Cockpit with two large cockpit lockers, easy to access life raft stowage in the floor, halyard stowage box on both sides of helmsman position close to winches and jammers.

**HANSE STANDARD** Modern and effective T-speed-keel with extra safe keel to hull-assembly from the massive bottom structure and strong high quality stainless steel bolts. Exceeds CE requirements.

**COACH ROOF** One step high elegant and easy to walk over coach roof with integrated curved flush hatches. Operable coach roof side windows. Hull with slightly higher freeboard for a low coach roof line and with a maximum LWL for fast cruising.

 The new H575 is precisely designed around the customer needs of the target group

Target Group

Hanse Customers

Switchers

Charter Companies

“Downsizers”

Customer needs

Fast under  
sails & engine

Easy sailing  
& safety

Innovative Design

Highest living  
Comfort

Value for money





# Customer Benefits – What is new?



## Fast Cruising

- J&V & co Design
- Longer LOA (17,15m)
- Deeper T speed keel (2,85m)
- Larger self tacking jib
- 3-blade folding propeller now in standard
- 107 HP in standard engine, optional upgrade to 146 HP

## Easy Sailing & Safety

- All lines to helmsman position
- Integrated self tacking jib traveller
- Optional electric winches
- Safe deck with high bulwarks
- AGM batteries
- Vynilester sandwich construction
- Main bulkhead laminated to the hull and deck

## Innovative Design

- Very sleek coach roof design - hidden by new bulwarks
- Longitudinal dinghy garage for jet tender
- 12 flush hatches - plenty of natural light and ventilation
- All hatches flush and some curved parallel to deck edge
- 2 Scoops
- Customization with more than 1.200 combinations

## Value for money

- Lowest price in
- 57-59 foot class
- Best value price ratio

## Highest living comfort

- Comfortable access to the sea with huge bathing platform with integrated swimming ladder
- Best in class companionway – flat 50°
- Best in class cockpit with 2 retractable easily transferable tables to huge sunbed
- Lots of refrigeration
- Best in class galley
- Unique sleeping space for charter - up to 13 berths
- More fuel capacity, 540 l
- Plenty of storage space
- Life raft storage

# Further Customer Benefits

## Style & Trend

- 3 wood options (Mahogany, Oak, Cherry)
- 3 floorboard options (Maple, Noce Nero, Stripes)
- 28 upholstery options
- Wood at companionway
- Indirect lighting
- LED overhead lights + dimmer (Lighting Package)
- Multifunction companionway area
- Large chill out area in saloon with retractable saloon table

## User friendliness

- Larger berths
- Larger workspace in galley
- More home appliances (extra fridge, microwave, coffee maker...)
- More light under deck (direct and indirect)
- Larger and flatter companion way
- Vanity table in fwd cabin
- Retractable electric saloon table
- Retractable electric cockpit table, transferable into huge XXL sunbed
- Lights dimmer

## Utilities

- Air condition optional
- Generator optional
- Hot water heating system
- Double cockpit tables
- Inmast furling system

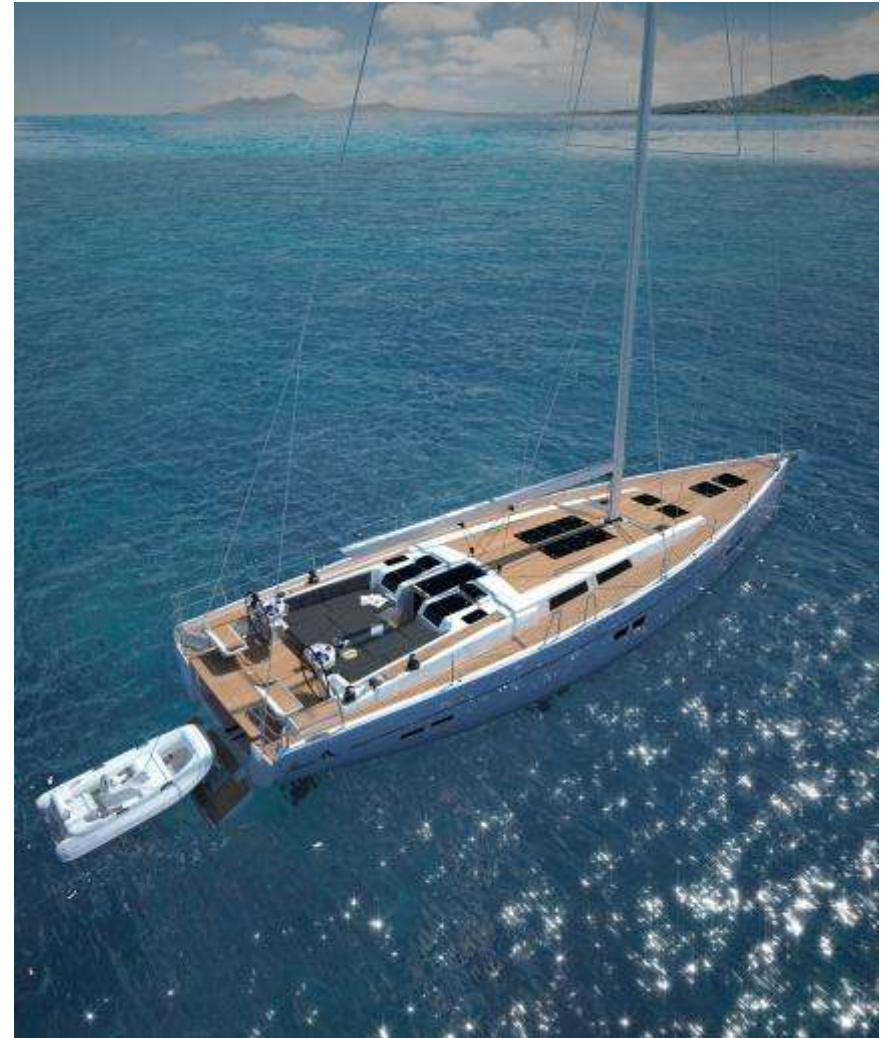



LOA	17,15 m
Hull length	16,70 m
LWL	15,15 m
Beam	5,20 m
Draft standard	2,85 m
Draft shallow	2,25 m
Displacement	19.500 kg
Ballast std keel	5.900 kg
Ballast opt keel	6.800 kg
Engine std, shaft drive	78 kW / 107 HP
Engine opt, shaft drive	110 kW / 150 HP
Water capacity (plastic)	810 l
Fuel capacity (plastic)	540 l
Waste water (plastic)	70 l + 85 l
Water heater	40 l

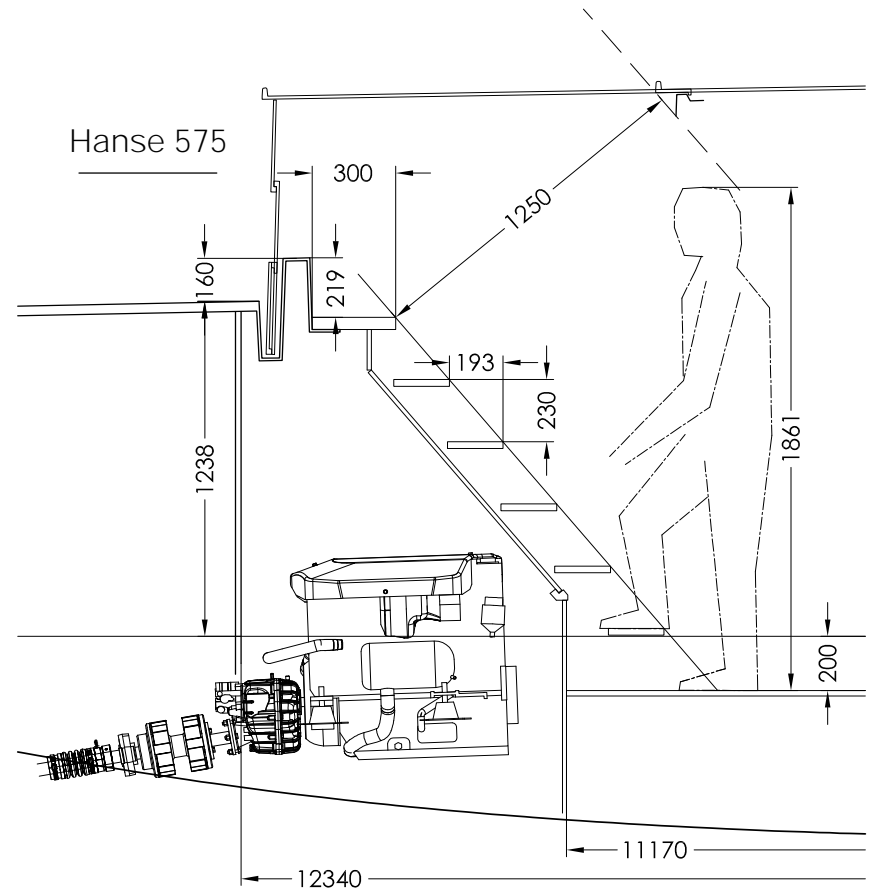

Lox	=	17,15	m
Lwl	=	16,69	m
Lwl	=	15,15	m
Beam	=	5,20	m
Droft	=	2,85 / 2,45*	m
Displ <sub>max</sub>	=	19 200 / 20 000*	Kg
Ballast	=	5 900 / 6 700*	Kg
RM @ 1°	=	385 / 385*	Kgm
RM @ 30°	=	12 900 / 12 900*	Kgm
Mainsail	=	87,5	m <sup>2</sup>
Jib (100%)	=	74,0	m <sup>2</sup>
Jib (110%)	=	63,0	m <sup>2</sup>
Mast top-DWL	=	25,30	m
Chain Plate (100%)	=	4,73	m
Sweepback angle	=	22,0	deg.
Engine	=	81/110	kW/hp

\* Shallow draft test

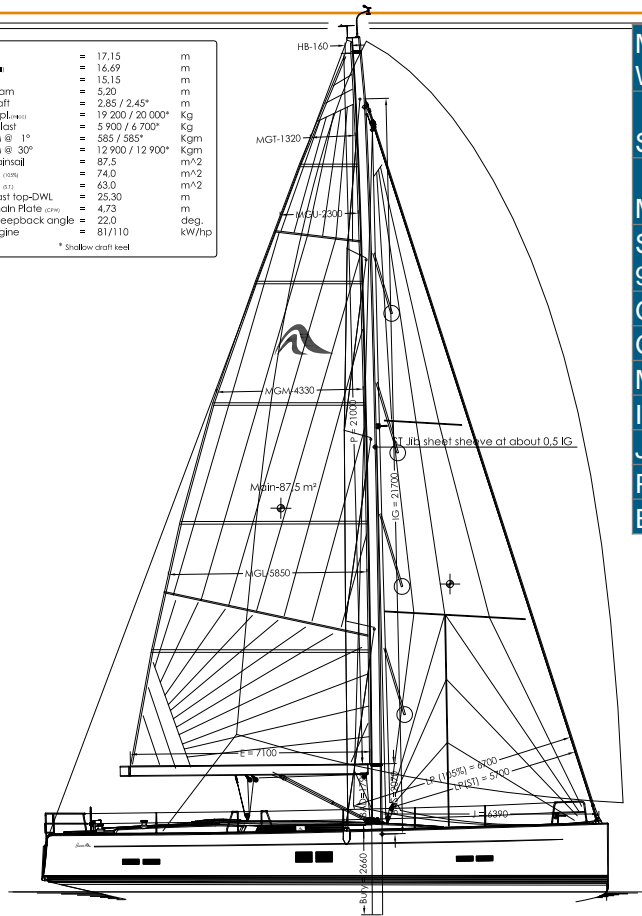

Mast length above WL	25,30 m
Sail area	160,5 m <sup>2</sup>
Main sail area	86,5/79 m <sup>2</sup>
Self tacking jib area 94%	66 m <sup>2</sup>
Genoa area, 105%	74 m <sup>2</sup>
Gennaker	210 m <sup>2</sup>
Mast manufacturer	Z-spar
I	20,70 m
J	6,40 m
P	21,00 m
E	7,10 m

Lox	=	17,15	m
Lwl	=	16,69	m
Lwl	=	15,15	m
Beam	=	5,20	m
Droft	=	2,85 / 2,45*	m
Displ <sub>max</sub>	=	19 300 / 20 100*	Kg
Ballast	=	5 900 / 6 700*	Kg
RM @ 1°	=	570 / 570*	Kgm
RM @ 30°	=	12 500 / 12 400*	Kgm
Mainsail	=	79,0	m <sup>2</sup>
Jib (100%)	=	74,0	m <sup>2</sup>
Jib (110%)	=	63,0	m <sup>2</sup>
Mast top-DWL	=	25,30	m
Chain Plate (100%)	=	4,73	m
Sweepback angle	=	22,0	deg.
Engine	=	81/110	kW/hp

\* Shallow draft test

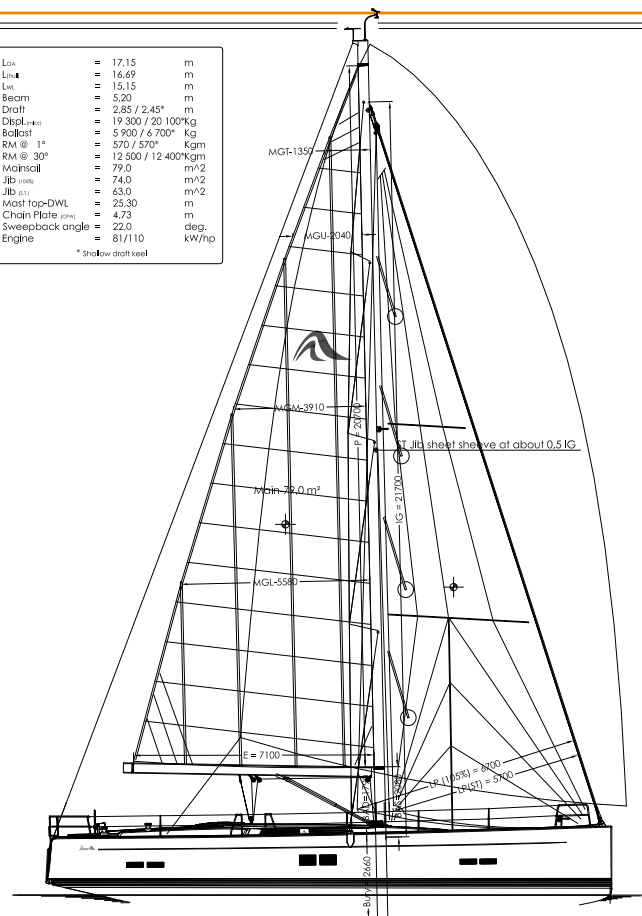

02	Stability dates changed	15/05/12	BR	
01	Temporary furling arrangement changed and R/L for furler to be added	12/05/12	BR	
01		20/03/12	BR	
001				DRAWN/ APPROVED

Judel/vrolijk PROPRIETARY  
THE INFORMATION CONTAINED HEREON IS THE PROPERTY OF JUDDEL/VROLIJK. IT IS TO BE USED ONLY FOR THE SPECIFIC PROJECT AND IS NOT TO BE REPRODUCED OR TRANSMITTED IN ANY FORM OR BY ANY MEANS, ELECTRONIC OR MECHANICAL, INCLUDING PHOTOCOPYING, RECORDING, OR BY ANY INFORMATION STORAGE AND RETRIEVAL SYSTEM. WITHOUT PERMISSION IN WRITING FROM JUDDEL/VROLIJK, NO PART OF THIS DOCUMENT MAY BE REPRODUCED OR TRANSMITTED IN ANY FORM OR BY ANY MEANS, ELECTRONIC OR MECHANICAL, INCLUDING PHOTOCOPYING, RECORDING, OR BY ANY INFORMATION STORAGE AND RETRIEVAL SYSTEM.

**HANSE 575**  
SAIL PLAN, CONVENTIONAL  
1:80 SCALE 1 OF 1  
Judel/vrolijk & co - engineering gmbh  
AM ALTEN VORHAREN 8  
27568 BREITENHAVEN  
GERMANY  
TELEFON +49 (0)471 30 80 11-0  
TELEFAX +49 (0)471 30 80 11-30  
E-MAIL info@judelvrolijk.com

DU TOEGEBORGE TOEGANGSRECHTEN ALLE RECHTEN ZIJN OP DE DIT DOCUMENT AAN HANSE 575 TOEGEDIEN. ALLE ANDEREN OP DE DIT DOCUMENT ZIJN NIET TOEGEDIEN.

01	Stability dates changed	15/05/12	BR	
00		12/05/12	BR	
001				DRAWN/ APPROVED

Judel/vrolijk PROPRIETARY  
THE INFORMATION CONTAINED HEREON IS THE PROPERTY OF JUDDEL/VROLIJK. IT IS TO BE USED ONLY FOR THE SPECIFIC PROJECT AND IS NOT TO BE REPRODUCED OR TRANSMITTED IN ANY FORM OR BY ANY MEANS, ELECTRONIC OR MECHANICAL, INCLUDING PHOTOCOPYING, RECORDING, OR BY ANY INFORMATION STORAGE AND RETRIEVAL SYSTEM. WITHOUT PERMISSION IN WRITING FROM JUDDEL/VROLIJK, NO PART OF THIS DOCUMENT MAY BE REPRODUCED OR TRANSMITTED IN ANY FORM OR BY ANY MEANS, ELECTRONIC OR MECHANICAL, INCLUDING PHOTOCOPYING, RECORDING, OR BY ANY INFORMATION STORAGE AND RETRIEVAL SYSTEM.

**HANSE 575**  
SAIL PLAN, FURLING  
1:80 SCALE 1 OF 1  
Judel/vrolijk & co - engineering gmbh  
AM ALTEN VORHAREN 8  
27568 BREITENHAVEN  
GERMANY  
TELEFON +49 (0)471 30 80 11-0  
TELEFAX +49 (0)471 30 80 11-30  
E-MAIL info@judelvrolijk.com

DU TOEGEBORGE TOEGANGSRECHTEN ALLE RECHTEN ZIJN OP DE DIT DOCUMENT AAN HANSE 575 TOEGEDIEN. ALLE ANDEREN OP DE DIT DOCUMENT ZIJN NIET TOEGEDIEN.





# Deck Layout: Easy Sailing & Innovative Design

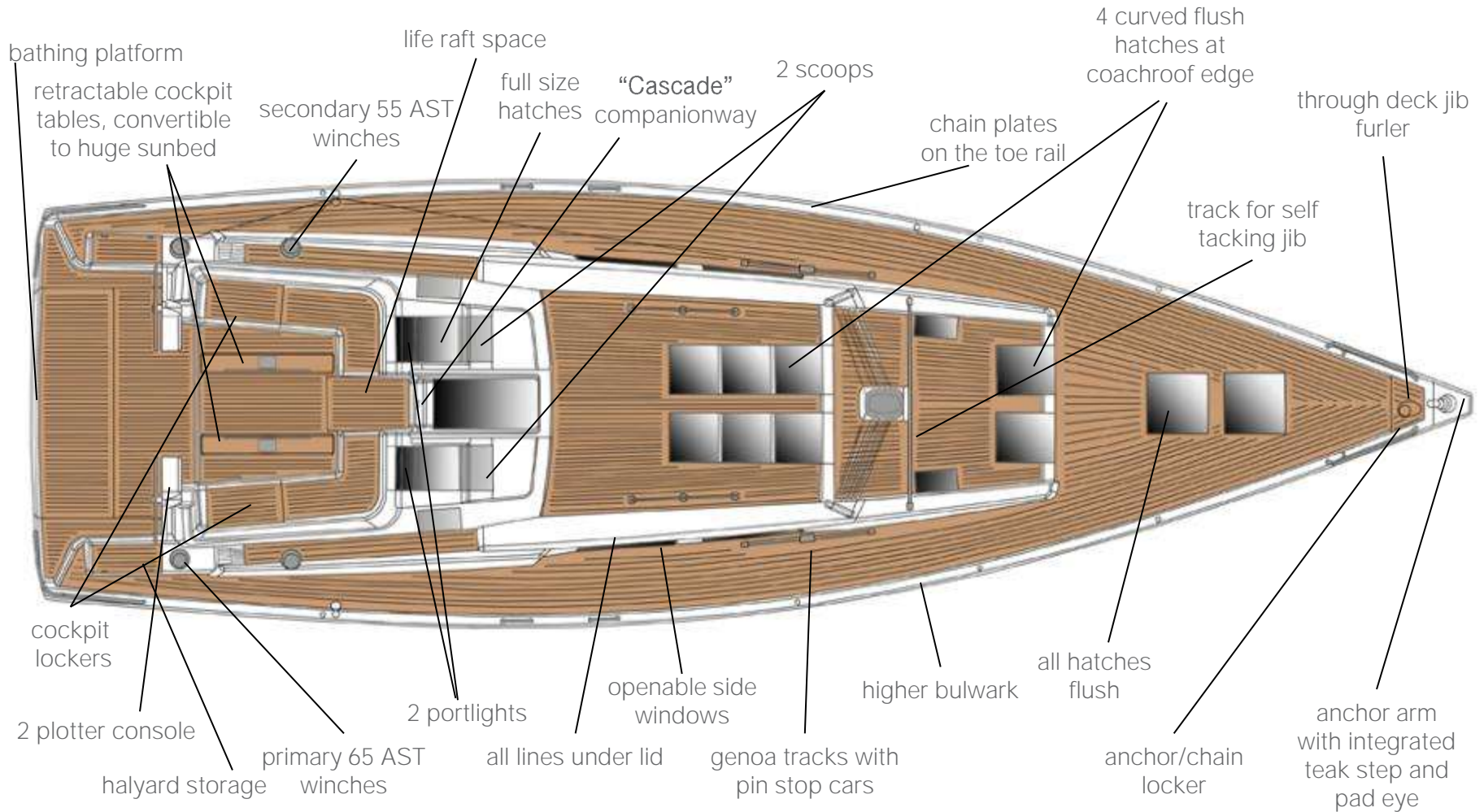

# Interior Layout – A1/B1/C1/D2 (standard)

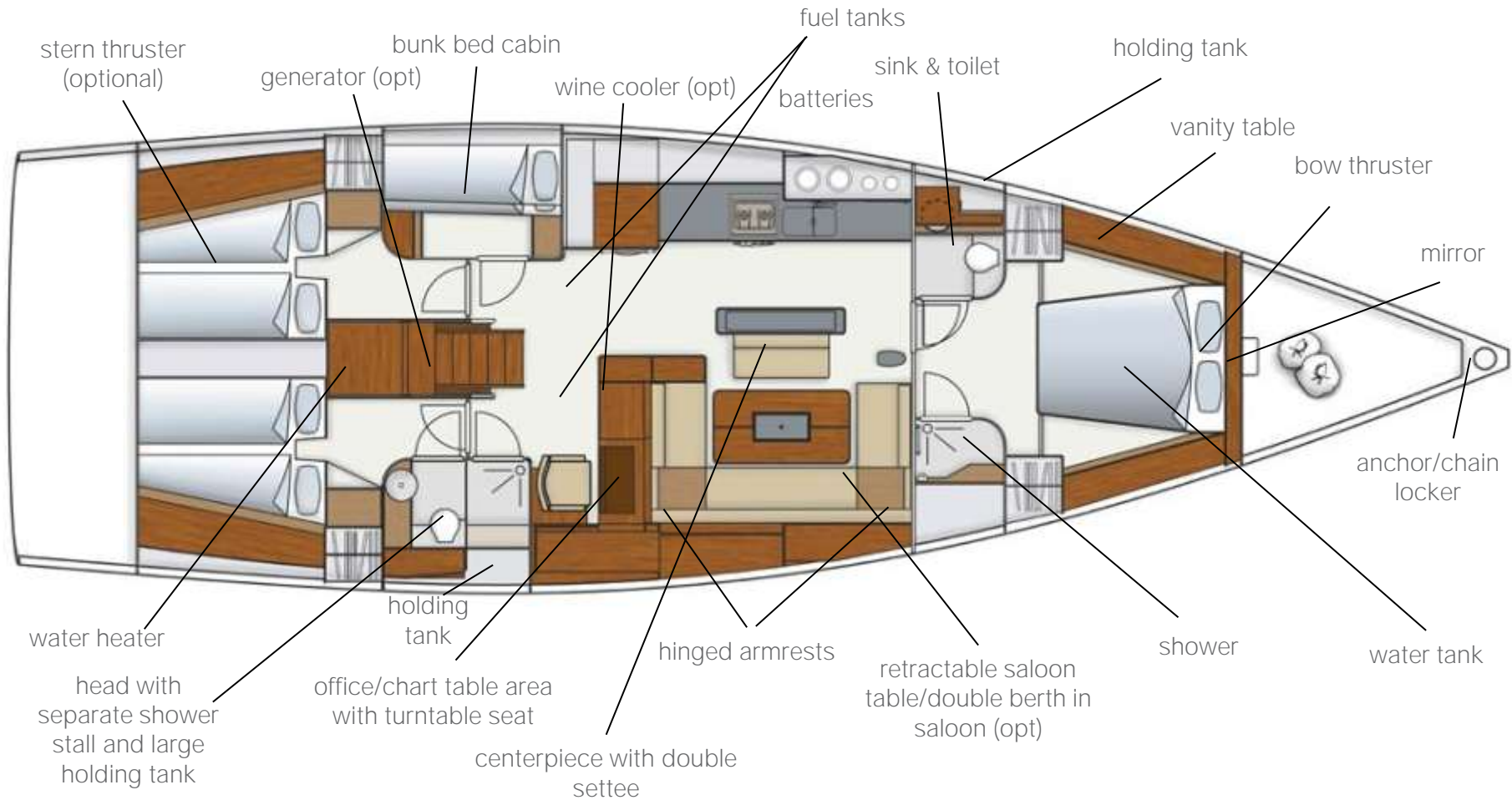



# Interior Layout – A1/B2/C2/D2 (optional)

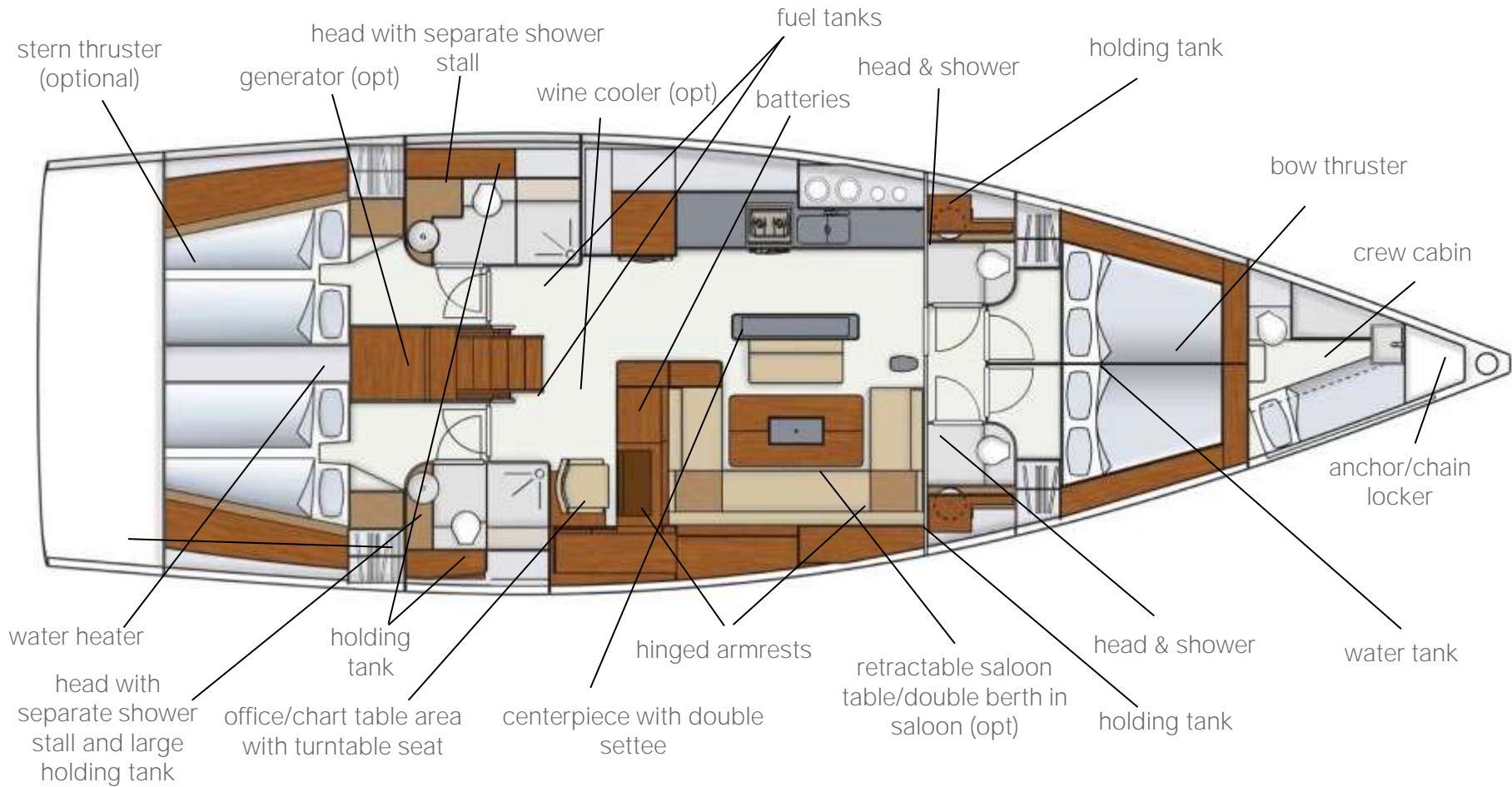

A1  
std

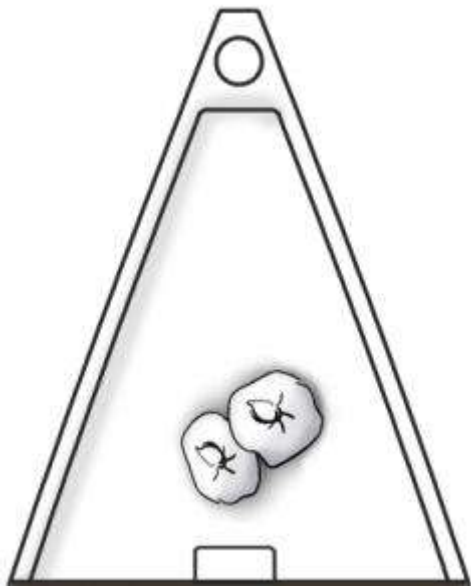

- Sail locker
- Large opening flush hatch access
- Access to chain locker and windlass
- Deck wash pump fitting (optional)
- Watermaker (optional)
- Ladder

A2  
opt

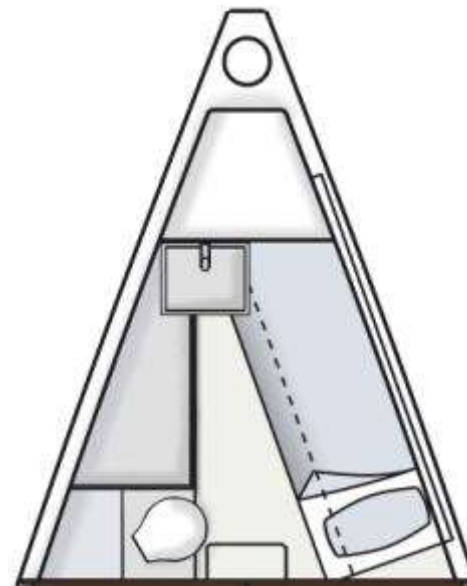

- Crew cabin
- Sink
- Manual toilet
- Storage space under berth
- Large opening flush hatch access
- Access to chain locker and windlass
- Deck wash pump fitting (optional)
- Ladder



## Interior Layout – B section

B1  
std

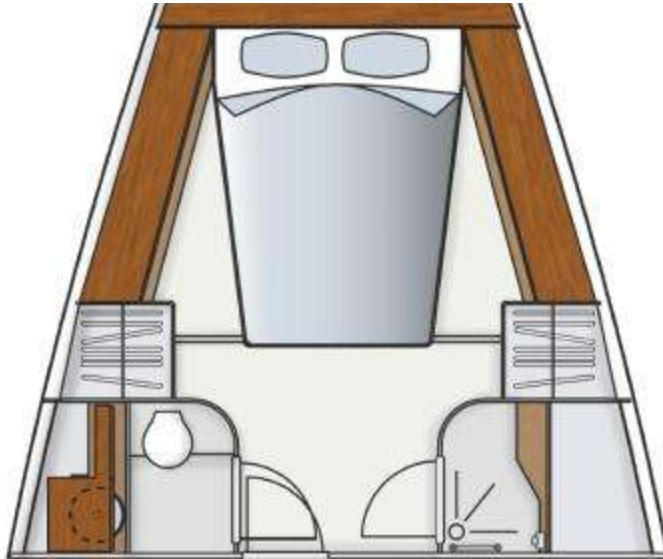

- Large double “island” berth
- Hanging lockers along the hull
- Shelves along the hull
- Large storage under berth
- Access to the retractable bowthruster
- Locker with shelves port and stb
- Vanity table
- Separate head on port
- Separate shower stall on star bord
- 3 large deck flush hatches for the cabin
- 2 small deck flush hatches for head and shower
- 4 hull port lights with Venetian blinds
- Storage lockers on the fwd bulkhead

B2  
opt

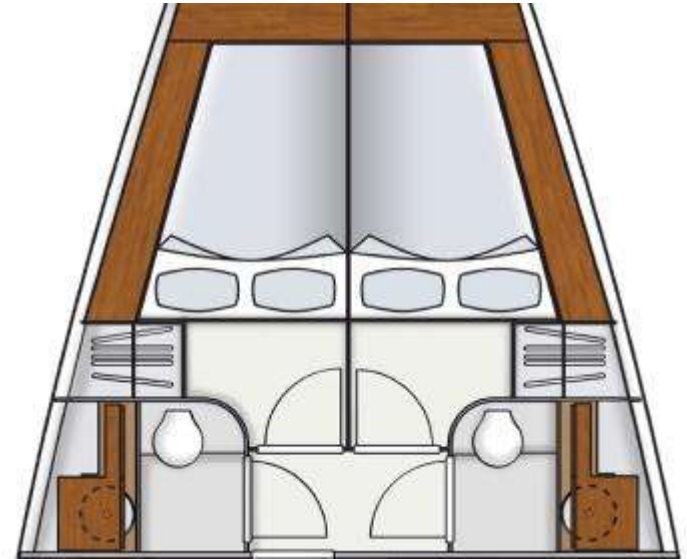

- 2 identical cabins with double berth
- Hanging lockers along the hull
- Shelves along the hull
- Large storage under berth
- Access to the retractable bow thruster
- Locker with shelves port and starbord
- 2 x head with shower
- 3 large deck flush hatches for the cabins
- 2 small deck flush hatches for head and shower
- 4 hull port lights with Venetian blinds
- Storage lockers on the fwd bulkhead

## Interior Layout – C section

C1  
std



- Longitudinal full-size galley on port (358 cm)
- Black Corian worktop in galley (276 cm)
- Microwave, double drawer dishwasher or washing machine, microwave, icemaker/freezer drawer in galley (optional)
- Vent hood in galley
- Centerpiece with double settee
- Comfortable U-shape settee on starboard with folding armrests in corners
- Large folding saloon table (retractable optionally)
- Generous office/chart table area on port with turnable seat with armrest
- Bunk bed cabin on port with storage lockers
- Head with separate shower stall on starboard
- Bar locker at the chart table
- 50 degrees companionway stairs angle
- Lockers along the hull
- TV lifter in centerpiece (optional)
- 6 full size flush hatches in saloon
- 4 full size port lights in saloon
- 2 small flush hatches for bunk cabin and head
- 4 side opening coach roof windows



## Interior Layout – C section

C2  
opt



- Longitudinal full-size galley on port (356 cm)
- Black Corian worktop in galley (276 cm)
- Microwave, double drawer dishwasher or washing machine, microwave, icemaker/freezer drawer in galley (optional)
- Vent hood in galley
- Centerpiece with double settee
- Comfortable U-shape settee on stb with hinged armrests in corners
- Large folding saloon table (retractable optionally)
- Generous office/chart table area on port with turnable seat with armrest
- Larger head with separate shower stall on port
- Head with separate shower stall on starboard
- Bar locker at the chart table
- 50 degrees companionway stairs angle
- Lockers along the hull
- TV lifter in centerpiece (optional)
- 6 full size flush hatches in saloon
- 4 full size port lights in saloon
- 2 small flush hatches for heads
- 4 side opening coach roof windows

## Interior Layout – D section

D2  
std

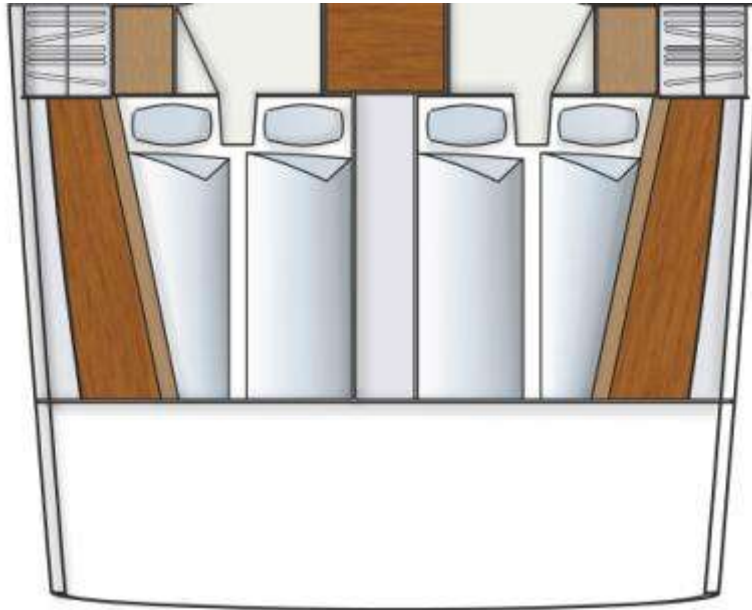

- Double aft cabins
- Separate berths with inserts
- Large lockers
- Lockers along the hull
- Opening full size flush hatches
- 2 x opening port lights in cockpit
- 2 x opening port lights in garage
- 4 hull port lights
- Access to head on starbord from aft cabin
- Access to head on port from aft cabin (only at C2 layout)
- Access to main engine



# New Jet Tender Dinghy Garage

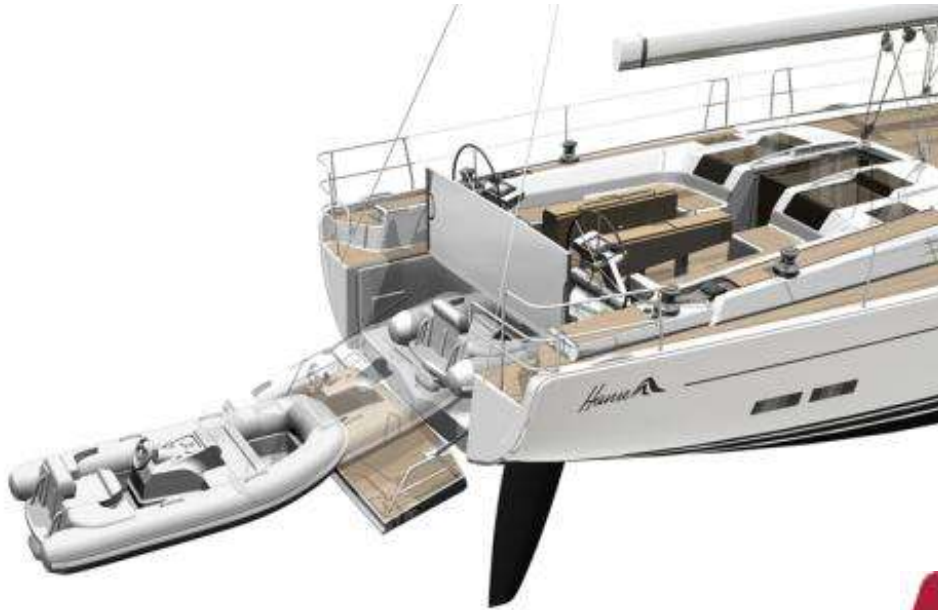

- Cockpit flap hinged and openable
- Large powered bathing platform
- Integrated ladder in bathing platform
- Access stairs
- Double gas bottle locker
- Tender launching system with rollers (optional)
- Electric windlass for tender (optional)
- Air pump (optional)

**TURBOJET**  
**285**



LOA	2,89 m
Beam	1,69 m
Seating	3 persons
Dry weight	290 kg
Engine	98 hp 4-stroke Weber
Top speed	42 Knots

**WILLIAMS**  
performance tenders

**Hanse**  
BREAKING RULES . SETTING TRENDS

[www.hanseyachts.com](http://www.hanseyachts.com)

# Interior with plenty of living space and comfort

## INTERIOR - Measurements (cm)

layout	headroom	berth size	bench size
A1	210	200 x 60	N/A
B1	210	205 x 162	N/A
B2	210	205 x 152	N/A
C1 (saloon)	217	285 x 150	285 x 150
C1 (bunk cabin)	215	195 x 75	N/A
D2	228	205 x 160 (115)	N/A
Head (B1/B2)	210	N/A	N/A
Head (C1/C2)	215	N/A	N/A



## POLAR DIAGRAM & STABILITY CURVE

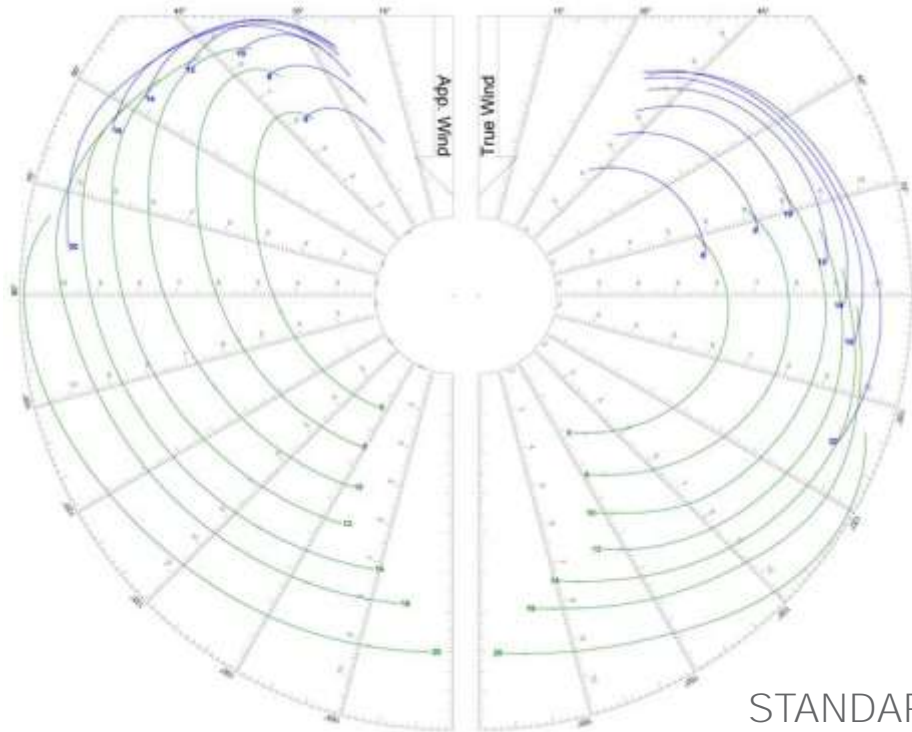

STANDARD DRAFT

### Stability Curve

Made by MSURF from model H11A-HYD 15-May-2012 16:08:02

Displ't = 19199,99 kg XCG = 8,800 m YCG = 0,000 m ZCG = 0,300 m

Specific Weight = 1026,500000 kg/m<sup>3</sup> Trim: Free

18.05.2012 18:14:41

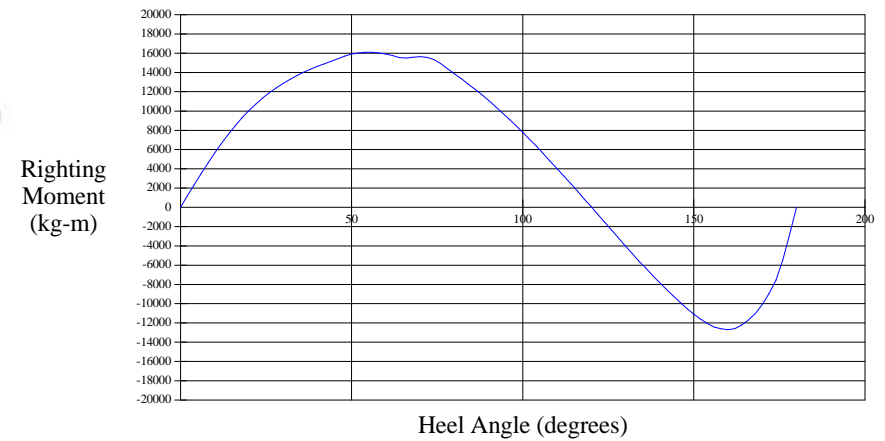



## POLAR DIAGRAM & STABILITY CURVE

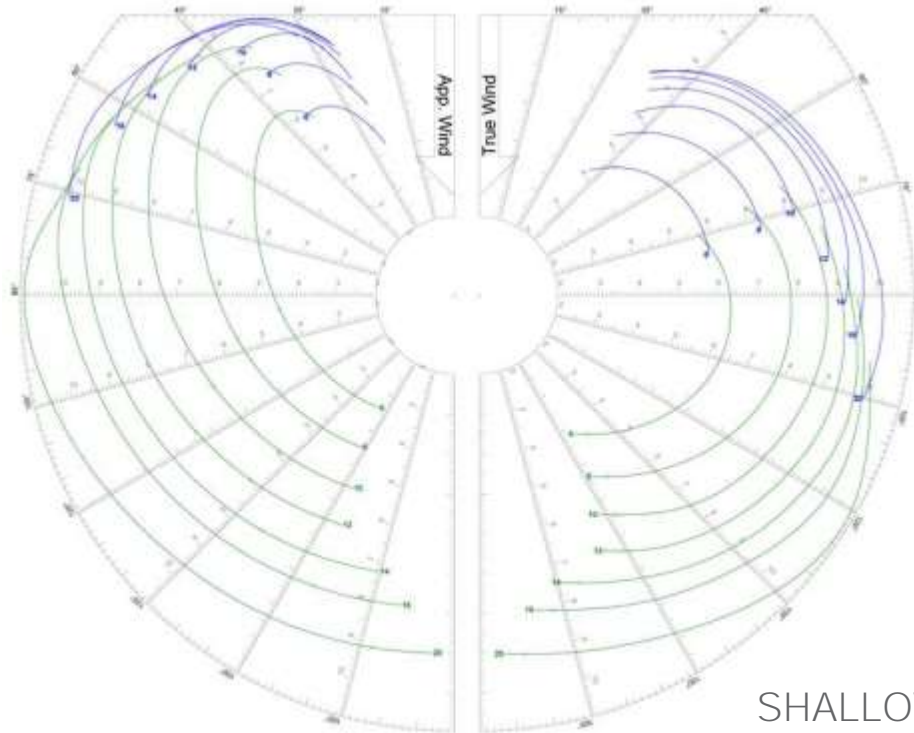

### Stability Curve

Made by MSURF from model H11A-HYD 15-May-2012 16:08:02

Displ't = 20000,06 kg XCG = 8,850 m YCG = 0,000 m ZCG = 0,360 m

Specific Weight = 1026,500000 kg/m<sup>3</sup> Trim: Free

18.05.2012 18:17:11

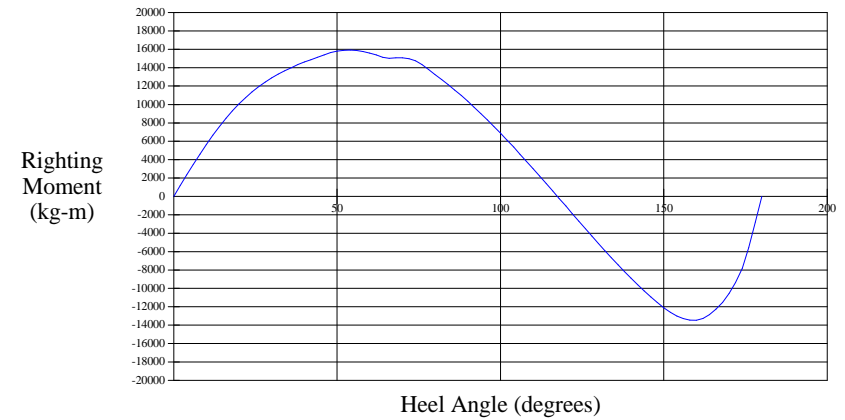

SHALLOW DRAFT

SIMRAD RS25 VHF with AKH05 remote



SIMRAD NSS12 Chart plotter



- + Engine info interface
- + SIMRAD Autopilot with Flux Gate Compass RC42 Giro
- + Mast head unit

SIMRAD NSS12 Chart plotter



SIMRAD 2 x IS40 Full displays



SIMRAD 2 x IS40 Full displays



SIMRAD Autopilot controller

SIMRAD VHF with AKH05 remote



B&G 2F12 Chart plotters

B&G 2F12 Chart plotters



- + Engine info interface
- + SIMRAD Autopilot with Flux Gate Compass RC42 Giro
- + Mast head unit



B&G Triton T41

B&G Triton T41



B&G Autopilot controller





# Additional Electronics

SIMRAD IS40 multifunctional display (speed/wind/depth)



SIMRAD 4G broadband radar



SIMRAD NSE8 Chart plotter at chart table



SIMRAD NAIS 300 AIS Class B transponder



# Fusion/Bose Entertainment Package

Saloon

FUSION MS-AV700  
CD/DVD/USB player (chart table)



FUSION MS-DKIPUBS:  
dock for iPhone/iPod/USB (chart table)



4 High end 2-way speakers  
(headliner)



WLAN access point (saloon)

Cockpit

FUSION MS-NRX200  
remote control (cockpit)



BOSE 131: 2 speakers (cockpit)



## TV Package Saloon

SAMSUNG TV 32" LED flat  
TV lifting system (centerpiece in saloon)  
All-in-one Antenna (VHF, FM Radio, TV  
analogue, DVBT)  
TV preparation



\*only possible with Entertainment package



FUSION MS-IP600 incl. dock iPhone/iPod/USB



2 High-end 2-way speakers, black



## TV Package Owner's Cabin

22" flat TV

CD/DVD player integrated

Cradle for TV

Installation



# New Designed High Quality Sprayhoods & Biminis

- Sprayhoods of extra high quality Makrilux tissue in light grey, dark blue & cream
- Sprayhood & Bimini professionally mounted at the yard by Wendel & Rados

Headroom (sprayhood): 165 cm

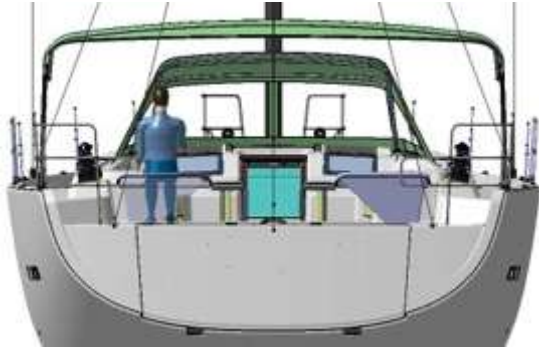

Headroom (bimini): 190 – 205 cm

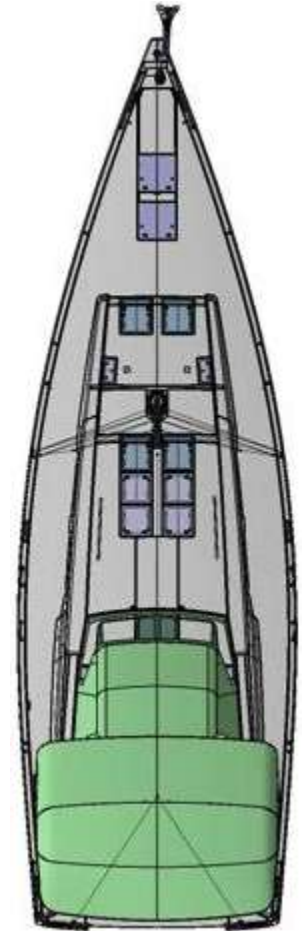



### 3 Woods

Mahogany Style (Std)



Italian Oak Style



American Cherry Style



### 3 Floors

Maple Style (Std)



Noce Nero Style



Stripes Style



## Hull and Waterline



## 30 Upholsteries

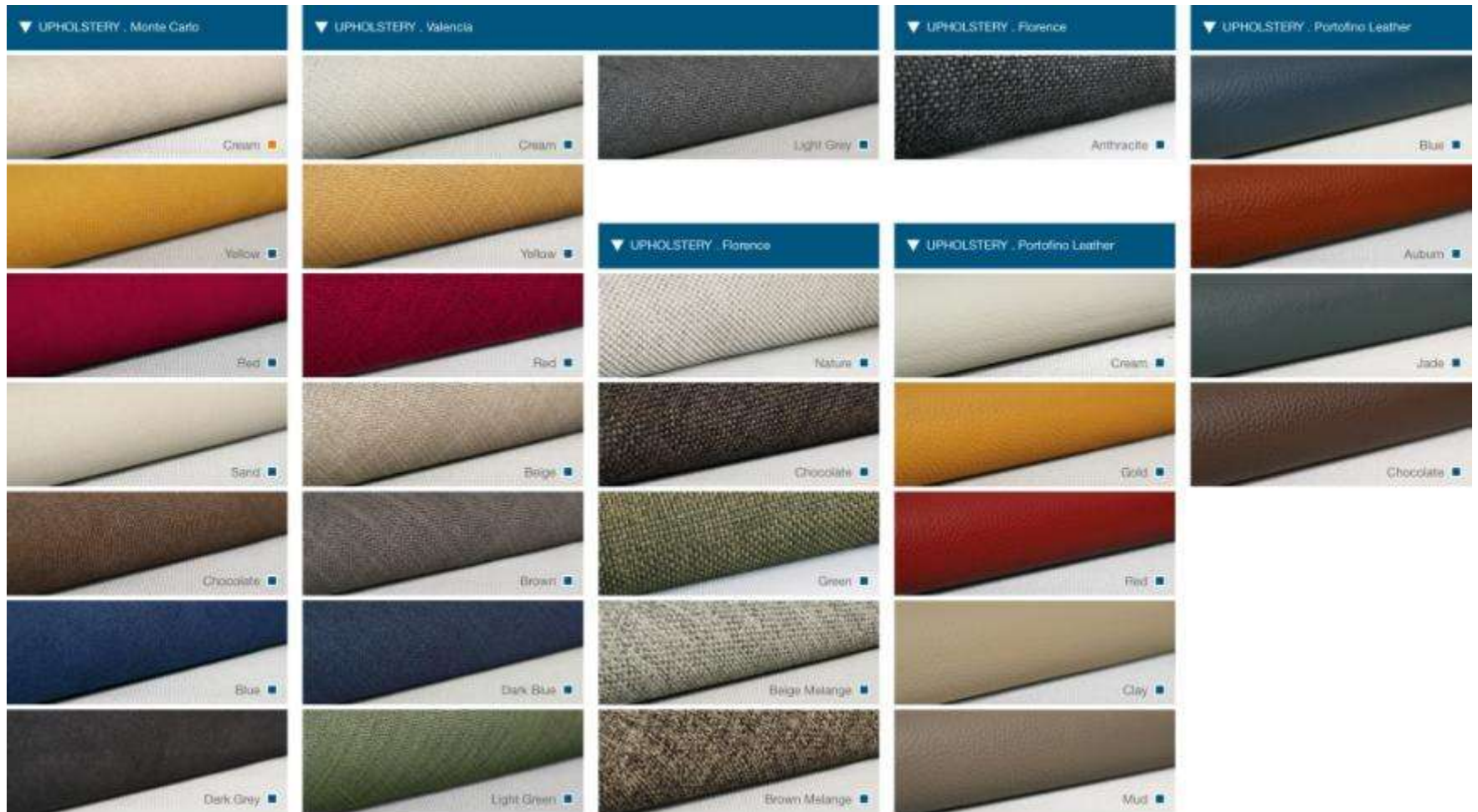



# Individual Customization

## Maindrop/Bimini/Sprayhood and Cockpit Upholstery

### ▼ MAINDROP/BIMINI/SPRAYHOOD



### ▼ COCKPIT UPHOLSTERY



## HANSE 545 vs 575

Model	Hanse 545	Hanse 575
Builder	HanseYachts	HanseYachts
Model year	2009	2012
LOA	16,20	17,15
Hull length (m)	16,08	16,70
LWL	14,60	15,15
Beam (m)	4,91	5,20
Weight (t)	18,7	19,5
Ballast weight (t)	5,3	5,8
Displacement/ballast ratio	28,34%	30,26%
Draft Std. (m)	2,80	2,85
Sail area (m <sup>2</sup> )	156	160,5
Air draft	24,80	24,30
Engine Std.	Volvo 75	Volvo 110
Water capacity (l)	700	810
Fuel capacity (l)	400	2 x 270
Fridge (l)	130	140
CE category	A	A
Cabins Std.	3	5
Head Std.	2	2
<b>BASIC PRICE excl. VAT</b>	<b>278.500,00 €</b>	<b>339.000,00 €</b>



- MORE VERSATILE INTERIOR
- LARGER COCKPIT
- LONGITUDINAL GARAGE
- MORE ERGONOMICAL COCKPIT
- LARGER BATHING PLATFORM
- MORE NATURAL LIGHT INSIDE
- EASIER HANDLING
- LARGER JIB
- BETTER ANCHOR ARM
- LONGER LWL
- LESS EDGY INTERIOR
- LARGER GALLEY
- FLATTER COMPANIONWAY STAIRS
- MORE GADGETS
- BULWARK
- MORE STORAGE SPACE



- 12% more interior space
- 20% larger saloon table
- 15% more sitting area in saloon
- 20% flatter companionway stairs
- 10% larger cockpit
- 6% more beam
- 4% more LWL
- 25% larger galley worktop
- 10% more refrigeration (2<sup>nd</sup> fridge)









# The New Hanse 575 has plenty of new unique selling points

- Vinylester balsa core sandwich construction
- judel/vrolijk & co design
- Self tacking jib
- Easy handling
- Dinghy garage designed for jet tender
- Full function galley
- T speed keel
- Transferable sun bathing area in cockpit
- Versatile interior layouts
- Large opening bathing platform
- Main bulkhead laminated to hull and deck
- Full batten main sail
- Flush hatches
- High solid bulwark
- Individuality



## H 575 Launching Schedule – present at all major boat shows

	HISWA	Cannes	Southampton	Barcelona	Genoa	Paris	Dusseldorf
H575							
H575							
H575							
H575							