



# C57



## TECHNICAL DATA

## Preliminary Pricelist

C57

Length overall	16,73 m	54'9"
Length hull	16,16 m	53'1"
Length at waterline	15,50 m	50'9"
Beam overall	5,25 m	17'2"
Draft standard cast iron keel [approx.]	2,52 m	8'2"
Draft option cast iron keel as shallow keel [approx.]	1,99 m	6'5"
Displacement	17.130 kg	37.765 lbs
Ballast shallow keel	5.390 kg	11.883 lbs
Ballast deep keel	5.785 kg	12.754 lbs
Engine	Yanmar 4JH80, 59kW/80hp, sail drive	Yanmar 4JH80, 59kW/80hp, sail drive
Fuel tank [approx.]	500 l	110 gal
Water tank [approx.]	650 l	143 gal
Sail Area	136,5 m <sup>2</sup>	1.464 sq ft
Selftacking Jib	56,5 m <sup>2</sup>	603 sq ft
Mainsail	80 m <sup>2</sup>	861 sq ft
Genoa	69 m <sup>2</sup>	743 sq ft
Gennaker	232 m <sup>2</sup>	2.497 sq ft
Code 0	123 m <sup>2</sup>	1.324 sq ft
Height of mast above water line [approx.]	24,26 m	79'6"
I	20,40 m	66'9"
J	6,20 m	20'3"
P	20,00 m	73'9"
E	6,88 m	22'6"
CE Category	A	A
Design	Cossutti Yacht Design	Cossutti Yacht Design

BASE PRICE EX WORKS (EXCL. VAT)

374.900,00 €

**Hull**

Hull colour Signal white with Silk grey cove- and waterline, gelcoat  
Vacuum infused hull in sandwich construction

**Keel**

L-shaped keel, cast iron, draft 2,52m

**Steering System**

Twin wheel steering system  
Twin rudders

**Propulsion Standard**

Diesel engine  
Engine throttle control, mounted on side of steering pedestal, stb side, mechanical  
3 blade fixed propeller

**Interior layout**

A1: Sail locker  
B1: Queen size "island" double berth with ensuite bathroom and separate shower stall incl. storage space  
C1: Saloon incl. full function galley fwd, dining area on port, lounge area and chart table on stb (only with D1)  
D1: Twin cabin with "scissor" bed incl. ensuite bathroom and separate shower stall on port, double berth incl. ensuite bathroom on stb (only with C1)

**Interior styling**

"Classic" Mahogany interior, floor in "Oceanline" optic  
Solid worktop surface in galley "Brown stone"

**Upholstery**

Upholstery "Vela" in saloon (according to Bavaria Style Guide)  
Mattress cover in cabins, white

**Cockpit & deck**

Cockpit floor, side deck and coach roof with non slip structure  
Integrated wet bar incl. sink with mixing tap (hot and cold water)  
5 spoke stainless steel steering wheels covered with leather  
Teak on cockpit benches and bathing platform  
2 cockpit tables, fixed  
All hatches flush  
Moulded staircase to access bathing platform

**Tender & toys**

Storage for toys or equipment on transom

**Mooring & Anchoring**

6 mooring cleats, stainless steel, fixed  
Stainless steel anchor arm with roller, fixed  
Anchor windlass, electrical

**Standing & running gear**

Aluminium standard keel stepped 2 spreader mast  
Under deck jib furling system  
Backstay adjuster, manual  
Rod kicker  
Midboom sheeting system  
Elvström Dacron mainsail & selftacking jib

**Winches**

2 x Lewmar 55ST EVO halyard winches, manual  
2 x Lewmar 55ST EVO secondary winches, manual

**Interior equipment**

2 burner stove with oven  
Drawer fridge incl. freezer unit on stb, totalling 160l  
LED overhead lights

**Plumbing System**

40 l water heater  
80 l holding tank, per toilet  
1 x manual bilge pump  
2 x electric bilge pump

**Electrical systems**

1 x engine battery, 12 V / 100 Ah, AGM  
2 x service batteries, 12 V / 2 x 100 Ah, AGM  
Battery charger, 40Ah (3 channels)  
230 V outlet in each cabin  
12V outlet with 2 USB connections at switch board  
Digital Switching System incl. multifunction display at chart table  
Country version EU/AUS

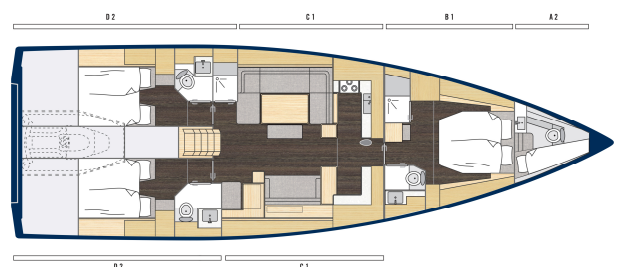
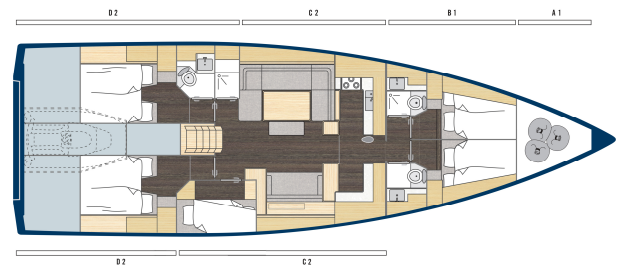
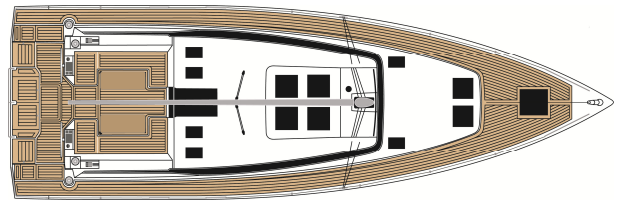

BASIC PACKAGE	
<b>Smart package [SP]</b>	15.900,00 € <input type="checkbox"/>
Bow thruster incl. battery, tunnel	
Teak on cockpit bottom	
Guard rail exit, both sides	
Anchor "Delta" 32kg, galvanized incl. chain, galvanized, 10mm, 50m	
Halyards in Dyneema quality	
Courtesy lights in saloon	
Courtesy lights in cockpit	
Ambient lights in saloon and cabins, dimmable	
12V outlet in cockpit	
Blinds, mosquito nets and curtains for hatches and porthlights - PREMIUM	
Handrail on ceiling [stainless steel]	
2 x Lewmar 65ST EVO halyard winches, manual	
6 mooring cleats, aluminium, retractable	
3 burner stove with oven	
Extractor hood in galley	
<b>Upgrades "Smart" Package</b>	
Bow thruster incl. battery, retractable	3.620,00 € <input type="checkbox"/>
Anchor "Delta" 32kg, stainless steel incl. chain, stainless steel, 10mm, 50m	2.030,00 € <input type="checkbox"/>
2 lowerable cockpit tables convertible in sun bathing area, electric	3.420,00 € <input type="checkbox"/>
Anchor windlass with capstans, electrical	890,00 € <input type="checkbox"/>
2 x Lewmar 65EST EVO halyard winches, electrical	4.900,00 € <input type="checkbox"/>
Exclusive full standing height shower on transom	880,00 € <input type="checkbox"/>
<b>STYLE PACKAGES</b>	
<b>"Nautilus" [only for B1]</b>	1.800,00 € <input type="checkbox"/>
Upholstered headboard at Queen size "island" double berth	
Upholstered sofa skirting in saloon	
Fabric covered chart table	
Fabric covered handrails, 6 x cushions	
<b>"Savoy" Leather [only for B1]</b>	2.900,00 € <input type="checkbox"/>
Leather upholstered headboard at Queen size "island" double berth	
Leather upholstered sofa skirting in saloon	
Leather covered chart table	
Leather covered handrails, 6 x cushions	
<b>PERFORMANCE PACKAGE [PF]</b>	8.900,00 € <input type="checkbox"/>
Y-spoke composite steering wheels, white or black	
Genoa tracks with pin stop cars	
Elvström Sport tri-radial laminate mainsail & self tacking jib	
3 blade folding propeller	
<b>Upgrades "Performance" Package [U-PF]</b>	
Elvström EPEX high performance membrane mainsail & self tacking jib	10.250,00 € <input type="checkbox"/>
4 blade folding propeller	900,00 € <input type="checkbox"/>
<b>ELECTRONIC PACKAGES</b>	
<b>"Basic"</b>	6.900,00 € <input type="checkbox"/>
2 x Raymarine i70s instrument displays (one per helm station)	
Raymarine Ray70 VHF radio with AIS at chart table incl. cabling and antenna	
Raymarine Evolution autopilot incl. drive and P70 control unit	
<b>Upgrade "Smart" [incl. Basic]</b>	1.000,00 € <input type="checkbox"/>
Raymarine eS75 7" multifunction display (instrument console on stb)	
<b>Upgrade "Advanced" [incl. Basic]</b>	2.050,00 € <input type="checkbox"/>
Raymarine eS97 9" multifunction display (instrument console stb)	
2 x instrument console incl. stainless steel handrails (one per helm station)	
GoFree wireless link	
<b>Upgrade "Premium" [incl. Basic]</b>	6.000,00 € <input type="checkbox"/>
2 x Raymarine eS97 9" multifunction display (one per instrument console)	
2 x instrument console incl. stainless steel handrails (one per helm station)	
GoFree wireless link	
Raymarine RayMic, 2 <sup>nd</sup> station in cockpit	
NMEA engine information interface for chart plotter	
<b>ENTERTAINMENT PACKAGES</b>	
<b>"Basic"</b>	1.100,00 €
Fusion MS-UD650 unit with integrated UNI-Dock incl. bluetooth streaming, dual USB; Multi-Zone technology, at chart table	
2 x Fusion high end speakers in saloon	
2 x Fusion high end speakers in cockpit, watertight	

# PACKAGES

# Preliminary Pricelist

C57

PRICE EXCL. VAT

<b>Upgrade "Smart"</b> [incl. Basic]	250,00 €	<input type="checkbox"/>
Fusion MS-NRX200i wired remote control in cockpit		
Fusion wireless link		
<b>Upgrade "Premium"</b> [incl. Basic, only B1 Layout]	1.150,00 €	<input type="checkbox"/>
Fusion MS-NRX200i wired remote control in cockpit		
Fusion wireless link		
Fusion MS-RA205 unit in owner's cabin		
2 x Fusion high end speakers in owner's cabin		

# INDIVIDUAL OPTIONS

# Preliminary Pricelist

C57

PRICE EXCL. VAT

			Package
<b>HULL/KEEL</b>			
Hull colour Silk grey with Signal white cove- and waterline, gelcoat	5.000,00 €	<input type="checkbox"/>	
L-shaped keel, cast iron, shallow draft 1,99m	1.850,00 €	<input type="checkbox"/>	
L-shaped performance keel, cast iron/lead, draft 2,8m	12.800,00 €	<input type="checkbox"/>	
<b>PROPULSION</b>			
Yanmar 4JH110, 81kW/110hp, shaft drive	2.800,00 €	<input type="checkbox"/>	
Engine throttle control, mounted on stb instrument console, electronic [only with instrument console]	4.500,00 €	<input type="checkbox"/>	
2 <sup>nd</sup> engine throttle control, mounted on port instrument console, electronic [only with engine throttle control on stb, electronic]	2.800,00 €	<input type="checkbox"/>	
3 blade folding propeller	1.600,00 €	<input type="checkbox"/>	PF
4 blade folding propeller	2.600,00 €	<input type="checkbox"/>	U-PF
Bow thruster incl. battery, tunnel	6.880,00 €	<input type="checkbox"/>	SP
Bow thruster incl. battery, retractable	10.900,00 €	<input type="checkbox"/>	U-SP
Stern thruster, retractable [only with retractable bow thruster]	10.500,00 €	<input type="checkbox"/>	
<b>INTERIOR LAYOUT</b>			
A1: Sail locker	Standard	<input type="checkbox"/>	
A2: Crew cabin with sink, marine toilet, basin and storage space	3.900,00 €	<input type="checkbox"/>	
B1: Queen size "island" double berth with ensuite bathroom and separate shower stall incl. storage space	Standard	<input type="checkbox"/>	
B2: 2 double cabins incl. storage space, 2 bathrooms and "Flex" bulkhead fwd cabin system	3.800,00 €	<input type="checkbox"/>	
C1: Saloon incl. full function galley fwd, dining area on port, lounge area and chart table on stb [only with D1]	Standard	<input type="checkbox"/>	
C2: Saloon incl. full function galley fwd, dining area on port, lounge area on stb [only with D2, D3 & D4]	No charge	<input type="checkbox"/>	
D1: 2 twin cabins with "scissor" bed aft, incl. ensuite bathroom and separate shower stall on port and ensuite bathroom on stb [only with C1]	Standard	<input type="checkbox"/>	
D2: 2 twin cabins with "scissor" bed aft, incl. ensuite bathroom and separate shower stall on port and bunk cabin on stb [only with C2]	1.880,00 €	<input type="checkbox"/>	
D3: 2 twin cabins with "scissor" bed aft incl. ensuite bathroom and separate shower stall on port and multifunction cabin on stb [only with C2]	1.460,00 €	<input type="checkbox"/>	
D4: 2 twin cabins with "scissor" bed aft incl. ensuite bathroom and separate shower stall on port and utility room on stb [only with C2]	1.180,00 €	<input type="checkbox"/>	
Additional bunk bed in crew cabin, 180cm, foldable [only with A2 layout]	390,00 €	<input type="checkbox"/>	
Dining table, lowerable and folding, convertible in double berth, electric, incl. cushion for double berth	2.210,00 €	<input type="checkbox"/>	
2 Director's chair [replacing bench]	1.660,00 €	<input type="checkbox"/>	
<b>INTERIOR STYLING</b>			
"Club" Oak style interior furniture incl. Wenge floorboards	3.800,00 €	<input type="checkbox"/>	
"Elegant" Walnut style interior furniture incl. Elm floorboards	3.800,00 €	<input type="checkbox"/>	
Solid worktop in galley "Pure white stone"	450,00 €	<input type="checkbox"/>	
<b>UPHOLSTERY [according to Bavaria Style Guide]</b>			
Upholstery "Nautilus" in saloon	980,00 €	<input type="checkbox"/>	
Upholstery "Savoy" in saloon, leather	4.750,00 €	<input type="checkbox"/>	
Upholstery "Opus" in saloon, artificial leather	1.100,00 €	<input type="checkbox"/>	
Luxury cold foam mattress with memory top for all berths	2.950,00 €	<input type="checkbox"/>	
Slatted frame in owners cabin [only for B1 layout]	400,00 €	<input type="checkbox"/>	
Carpet in saloon	1.650,00 €	<input type="checkbox"/>	
Carpet in owner's cabin [only for B1 layout]	990,00 €	<input type="checkbox"/>	
<b>COCKPIT UPHOLSTERY [according to Bavaria Style Guide]</b>			
Comfort cockpit cushions incl. backrests and 6 pillows	2.850,00 €	<input type="checkbox"/>	
Cockpit cushions inserts for lowerable tables	460,00 €	<input type="checkbox"/>	
Cockpit bench cushions	1.850,00 €	<input type="checkbox"/>	
Sun bed cushions on coachroof incl. headrest, storage pockets and cup holders	1.450,00 €	<input type="checkbox"/>	
Sun bed cushions on foredeck incl. headrest, storage pockets and cup holders	1.550,00 €	<input type="checkbox"/>	
<b>DECK FLOORING</b>			
Teak on cockpit bottom	1.900,00 €	<input type="checkbox"/>	SP

	PRICE	EXCL. VAT
Teak on side decks	16.400,00 €	<input type="checkbox"/>
Teak on coachroof	3.980,00 €	<input type="checkbox"/>
<b>COCKPIT &amp; DECK</b>		
Guard rail exit, both sides	770,00 €	<input type="checkbox"/> SP
"Sport" Y-spoke composite steering wheels, white or black	1.450,00 €	<input type="checkbox"/> PF
2 lowerable cockpit tables convertible in sun bathing area, electric	3.800,00 €	<input type="checkbox"/> U-SP
Drawer fridge incl. compressor at wet bar, 30l	1.750,00 €	<input type="checkbox"/>
BBQ in wet bar, gas	1.300,00 €	<input type="checkbox"/>
Courtesy lights in cockpit	480,00 €	<input type="checkbox"/> SP
Guard rail exit ladder, stainless steel	680,00 €	<input type="checkbox"/>
Exclusive full standing height shower on transom	980,00 €	<input type="checkbox"/> U-SP
<b>HOODS (according to Bavaria Style guide)</b>		
Sprayhood with handhold	2.750,00 €	<input type="checkbox"/>
Bimini top	4.250,00 €	<input type="checkbox"/>
Bimini top incl. LED overhead lighting	4.750,00 €	<input type="checkbox"/>
Composite T top with sliding roof	12.800,00 €	<input type="checkbox"/>
<b>TENDER &amp; TOYS</b>		
Canvas tender garage cover (according to Bavaria Style Guide)	320,00 €	<input type="checkbox"/>
Manual telescopic davits, retractable (240kg)	2.650,00 €	<input type="checkbox"/>
Full size jet tender longitudinal garage (max. 2,8m jet tender)	5.000,00 €	<input type="checkbox"/>
Launching system (only with longitudinal tender garage incl. rollers and electrical capstans)	4.880,00 €	<input type="checkbox"/>
12V Air compressor at transom for tender or toys	680,00 €	<input type="checkbox"/>
<b>MOORING &amp; ANCHORING</b>		
Stainless steel bow protection	450,00 €	<input type="checkbox"/>
6 mooring cleats, aluminium, retractable	1.600,00 €	<input type="checkbox"/> SP
Anchor "Delta" 32kg, galvanized incl. chain, galvanized, 10mm, 50m	1.350,00 €	<input type="checkbox"/> SP
Anchor "Delta" 32kg, stainless steel incl. chain, stainless steel, 10mm, 50m	3.600,00 €	<input type="checkbox"/> U-SP
Additional 50m chain, galvanized	900,00 €	<input type="checkbox"/>
Additional 50m chain, stainless steel	1.980,00 €	<input type="checkbox"/>
Anchor windlass with capstans, electrical, upgrade	990,00 €	<input type="checkbox"/> U-SP
Handheld chain counter (instead of std handheld)	390,00 €	<input type="checkbox"/>
Mooring kit (6 fender and 4 mooring lines)	640,00 €	<input type="checkbox"/>
Teak rubrail incl. stainless steel rail	3.950,00 €	<input type="checkbox"/>
<b>SAFETY</b>		
LFS - safety package, life safety system	285,00 €	<input type="checkbox"/>
Live saving collar with holding device and life line, installed at pushpit	190,00 €	<input type="checkbox"/>
<b>STANDING &amp; RUNNING GEAR</b>		
Carbon performance mast, boom and spreaders incl. rod rigging	on request	<input type="checkbox"/>
Composite "V" boom incl. sail cover (instead of std boom)	19.600,00 €	<input type="checkbox"/>
Elvström Sport tri-radial laminate mainsail & self tacking jib	6.600,00 €	<input type="checkbox"/> PF
Elvström EPEX high performance membrane mainsail & self tacking jib	19.400,00 €	<input type="checkbox"/> U-PF
Elvström Dacron 106% genoa (replacing self tacking jib, only with genoa tracks)	650,00 €	<input type="checkbox"/>
Elvström Sport 106% genoa (replacing self tacking jib, only with genoa tracks)	1.980,00 €	<input type="checkbox"/>
Elvström EPEX 106% genoa (replacing self tacking jib, only with genoa tracks)	6.450,00 €	<input type="checkbox"/>
Foresail reefing system, electrical	11.900,00 €	<input type="checkbox"/>
Backstay adjuster, hydraulic	1.870,00 €	<input type="checkbox"/>
Spreader lights, 4 pcs.	1.400,00 €	<input type="checkbox"/>
Fully battened mainsail with MDS-system, incl. 2 reefs, offshore-quality (replacing standard mainsail)	980,00 €	<input type="checkbox"/>
Inmast furling system for aluminum mast, manual	3.950,00 €	<input type="checkbox"/>
Inmast furling system for aluminum mast, electric	12.790,00 €	<input type="checkbox"/>
Elvström gennaker incl. Selden top down furler and Gennaker gear (halyard, sheets, blocks, halyard clutch and pad eye for gennaker tack)	7.800,00 €	<input type="checkbox"/>
Elvström Code 0 incl. Selden CX furler and Code 0 gear (halyard, sheets, blocks, halyard clutch and pad eye for Code 0 tack)	7.800,00 €	<input type="checkbox"/>
Lazy bags with lazy jacks (according to Bavaria Style guide)	1.150,00 €	<input type="checkbox"/>
Genoa tracks with pin stop cars	1.400,00 €	<input type="checkbox"/> PF
Halyards in Dyneema quality	1.200,00 €	<input type="checkbox"/> SP
<b>WINCHES</b>		
2 x Lewmar 65ST EVO halyard winches, manual	1.200,00 €	<input type="checkbox"/> SP
2 x Lewmar 65EST EVO halyard winches, electrical	6.800,00 €	<input type="checkbox"/> U-SP
2 x Lewmar 65ST EVO secondary winches, manual	1.200,00 €	<input type="checkbox"/>
2 x Lewmar 65EST EVO secondary winches, electrical	6.800,00 €	<input type="checkbox"/>
<b>INTERIOR EQUIPMENT Lights</b>		
Courtesy lights in saloon	440,00 €	<input type="checkbox"/> SP
Ambient lights in saloon and cabins, dimmable	720,00 €	<input type="checkbox"/> SP
<b>INTERIOR EQUIPMENT Water</b>		
Washer/dryer, 6kg, 220V (only with D3 or D4 layout)	1.800,00 €	<input type="checkbox"/>

	PRICE	EXCL. VAT	
Electric toilet with fresh water flush system for B1 layout	1.050,00 €	<input type="checkbox"/>	
2 x electric toilet with fresh water flush system for B2 layout	2.100,00 €	<input type="checkbox"/>	
2 x electric toilet with fresh water flush system for D1 layout	2.100,00 €	<input type="checkbox"/>	
Electric toilet with fresh water flush system for D2, D3 or D4 layout	1.050,00 €	<input type="checkbox"/>	
<b>INTERIOR EQUIPMENT Galley</b>			
3 burner stove with oven	220,00 €	<input type="checkbox"/>	SP
Microwave, 220V	560,00 €	<input type="checkbox"/>	
Dishwasher, 220V	1.650,00 €	<input type="checkbox"/>	
Dishwasher preparation	880,00 €	<input type="checkbox"/>	
Wine cooler, 220V	1.900,00 €	<input type="checkbox"/>	
Fridge on port	1.400,00 €	<input type="checkbox"/>	
Icemaker (only with D3 or D4 layout)	2.600,00 €	<input type="checkbox"/>	
Dedicated space for coffee machine incl. 220V socket	220,00 €	<input type="checkbox"/>	
Extractor hood in galley	680,00 €	<input type="checkbox"/>	SP
<b>INTERIOR EQUIPMENT Fresh Air</b>			
Air conditioning "Base", 32.000BTU for saloon and cabins incl. 2 <sup>nd</sup> shore power (220V/110V, only with generator)	11.500,00 €	<input type="checkbox"/>	
Air conditioning "Adria", 40.000BTU for saloon and cabins incl. 2 <sup>nd</sup> shore power (220V/110V, only with generator)	16.200,00 €	<input type="checkbox"/>	
Air conditioning "Gulf", 56.000BTU for saloon and cabins incl. 2 <sup>nd</sup> shore power (220V/110V, only with generator)	19.900,00 €	<input type="checkbox"/>	
<b>INTERIOR EQUIPMENT Heating</b>			
Hot air heating, 2 x 4kW, outlets in saloon and cabins, fuelling via diesel tank	6.350,00 €	<input type="checkbox"/>	
Ventilation fans in each cabin	1.200,00 €	<input type="checkbox"/>	
<b>ELECTRICAL SYSTEMS 230V</b>			
2 x extra service batteries, AGM	620,00 €	<input type="checkbox"/>	
12V outlet in cockpit	90,00 €	<input type="checkbox"/>	SP
Inverter 2000W (true sine wave) for 230V Shore power	2.200,00 €	<input type="checkbox"/>	
Inverter 2000W (true sine wave) for 110V Shore power	2.500,00 €	<input type="checkbox"/>	
Generator 4kW/5kVA, 2200-2800RPM 230V/50hz/110V	11.500,00 €	<input type="checkbox"/>	
Generator 8kW/10kVA, 2200-2800RPM 230V/50hz/110V	16.200,00 €	<input type="checkbox"/>	
Country version US/JPN	1.500,00 €	<input type="checkbox"/>	
<b>NAVIGATION EQUIPMENT</b>			
Raymarine Ray70 VHF radio with AIS at chart table incl. cabling and antenna	1.150,00 €	<input type="checkbox"/>	
Raymarine Evolution autopilot incl. drive and P70 control unit	4.990,00 €	<input type="checkbox"/>	
Raymarine eS97 9" multifunction display	2.450,00 €	<input type="checkbox"/>	
Raymarine RayMic, 2 <sup>nd</sup> station in cockpit	660,00 €	<input type="checkbox"/>	
Ramarine Quantum radar (only with chart plotter)	2.650,00 €	<input type="checkbox"/>	
Raymarine AIS350 Class B Receiver (only with chart plotter)	850,00 €	<input type="checkbox"/>	
Raymarine AIS650 Class B Transceiver (only with chart plotter)	1.280,00 €	<input type="checkbox"/>	
<b>ENTERTAINMENT</b>			
TV preparation in saloon	830,00 €	<input type="checkbox"/>	
40" flat TV incl. lifting mechanism, antenna and cabling in saloon	2.800,00 €	<input type="checkbox"/>	
22" flat TV with integrated DVD player incl. bracket and cabling (only for B1 layout)	1.680,00 €	<input type="checkbox"/>	
<b>MISCELLANEOUS</b>			
Blinds, mosquito nets and curtains for hatches and portlights	1.920,00 €	<input type="checkbox"/>	SP
Carbon gangway incl. bag, foldable, 220cm	1.830,00 €	<input type="checkbox"/>	
Underwater lights, white, 4 pcs.	1.760,00 €	<input type="checkbox"/>	
Electronic safe (only with B1 layout)	480,00 €	<input type="checkbox"/>	
Remote control for operating bathing platform	240,00 €	<input type="checkbox"/>	
Fresh water dockside inlet	470,00 €	<input type="checkbox"/>	
Handrail on ceiling, stainless steel	650,00 €	<input type="checkbox"/>	SP
Cockpit tables cover (according to Bavaria Style Guide)	580,00 €	<input type="checkbox"/>	
Steering wheels cover (according to Bavaria Style Guide)	380,00 €	<input type="checkbox"/>	
<b>SHIPMENT</b>			
Steel cradle for overseas transport	2.770,00 €	<input type="checkbox"/>	
Shrink wrap	820,00 €	<input type="checkbox"/>	

Smart Package (SP); Upgrade: Smart Package (U-SP); Performance Package (PF); Upgrades "Performance" Package (U-PF)

BAVARIA Yachtbau GmbH, Bavariastraße 1, D-97232 Giebelstadt, Phone +49 9334 942-0, Fax +49 9334 942-116, www.bavaria-yachtbau.com, info@bavaria-yachtbau.com

All prices are in EURO and are valid only in conjunction and at the time of ordering a new yacht ex works Giebelstadt. All weights and measurements are calculations based upon construction documents. Options may replaced standard equipments. The brochure is intended for advertisement only and is not part of a contract, warranty or of an offer. We reserve the right to modify or improve our products and to change specifications without notice. We are not liable for errors and printing mistakes. The expense of rigging out and launching is to be invoiced individually and separately. All rights are reserved to execute alterations in construction and equipment without notice. Aforementioned prices are recommended sales prices for deliveries ex works within 4 months of order placement. Later deliveries are subject to invoicing according to the then valid price list.

Version: 1/2017

Valid from 1<sup>st</sup> September 2016

Publication: 1<sup>st</sup> September 2016- Non binding preliminary pricelist

